

制造商和技术参数 Manufacturer and technical parameters

特性	Characteristics	HELI				
1.01 制造商	Manufacturer	HELI				
1.02 型号	Model	CPC(D)10/CPQ(Y)D10	CPC(D)15/CPQ(Y)D15	CPC(D)18/CPQ(Y)D18		
1.03 额定负荷	Rated capacity	kg	1000	1500	1800	
1.04 负载中心	Load center	mm	500			
1.05 动力种类	Power type	柴油Diesel/汽油Gasoline(石油液化气LPG)				
1.06 驾驶方式	Driving mode	座驾式Sit-on type				
1.07 整机自重	Service mass	kg	2300	2700	2900	
轮胎	Tyre					
2.01 前轮/后轮	Tyre(front/rear)	6.50-10-10PR/5.00-8-10PR				
尺寸	Size					
3.01 最大起升高度(标准)	Max.lifting height	H	mm		3000	
3.02 门架全高(货叉落地、门架垂直)	Mast height,lowered	H1	mm		1995	
3.03 货叉起升最大高度(带挡货架)	Mast height,extended	H2	mm		4014	
3.04 自由提升高度	Free lift	H3	mm		155	
3.05 最小转弯半径	Min.Turning radius	HR	mm	1955	1955	
3.06 全长(含货叉/不含货叉)	Overall length(with fork/without fork)	L	mm	3011/2241	3165/2245	3213/2293
3.07 全宽	Overall width	W	mm		1170	
3.08 全高(护顶架)	Overall height(overhead guard)	H4	mm		2035	
3.09 轴距	Wheel base	L1	mm		1400	
3.10 轮距(前轮距/后轮距)	Tread (front/rear)	W3/W4	mm		962/929	
3.11 前悬距	Front overhang	L2	mm	421	425	428
3.12 最小离地间隙(门架处)	Min.Ground clearance	H5	mm		110	
3.13 座椅上表面距护顶架距离	Distance from the seat surface to the overhead guard	H6	mm		970	
3.14 叉距(外侧)(最大/最小)	Distance across forks(max./min.)	W5	mm		950/200	
3.15 最小直角通道宽度	Min.Right angle aisle width	Ra	mm	2280	2280	2280
3.16 门架倾角	Mast tilt	α/β	°		6/12	
3.17 货叉尺寸	Fork size	mm	770x100x32	920x100x35	920x100x35	
性能	Performance					
4.01 起升速度(满载/空载)	Lghting speed:loaded/unloaded	mm/s	500/530			
4.02 下降速度(满载/空载)	Lowering speed:loaded/unloaded	mm/s	≤600/≥300			
4.03 行驶速度(满载/空载)	Travelling speed:loaded/unloaded	Km/h	14.5/14.5			
4.04 满载爬坡度	Gradeability(loaded)	%	23(22)	21(18)	19(17)	
4.05 最大牵引力(满载/空载)	Max/traction force:loaded/unloaded	KN	10.1/8.4	11.1/9	11/9.1	

驱动、传动控制装置		Drive and transmission control device	
5.01 蓄电池(电压/容量)	Battery voltage/capacity	V/Ah	柴油车:12/80;汽油、液化气车:12/60
5.02 发动机制造商/型号	Internal combustion engine model	全柴V25-45V42 新昌4D29V41 新昌NC485BPG 五十铃GK-C240NKF01 GCT K21	
5.03 发动机额定功率	Internal combustion engine rated output	kW/rpm	33.1/2600 36.8/2500 31/2600 34.6/2500 31.2/2200
5.04 发动机额定扭矩	Internal combustion engine rated torque	Nm/rpm	150/1600-1800 165/1600-1800 131/1700-1900 142/1800 143.7/1600
5.05 缸数-缸径x行程	Internal combustion engine number of cylinder	4-90x100 4-93x105 4-85x100 4-86X102 4-89x83	
5.06 发动机排量	Engine displacement	L	2.5 2.9 2.27 2.369 2.065
5.07 发动机燃油箱容量	Internal combustion engine fuel tank capacity	L	30 30 30 30 30
5.08 排放标准	Emission	国IV(内销) 国IV(内销) 国II(外销) 国III(外销)	
5.09 变速箱变速档数(前/后形式)	Transmission number of speed fwd/bwd type	1-1自动挡1-1Power Shift T/M/2-2手动换挡2-2Manual Shift T/M	

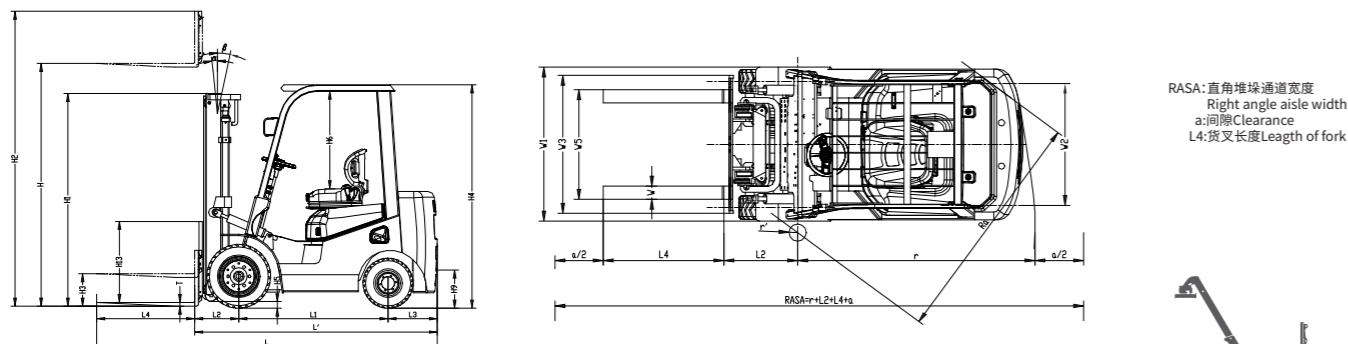

合力产品范围: 1-46吨内燃叉车; 0.6-35吨电动叉车; 前移式叉车、托盘车、堆垛车等仓储类产品;
AGV智能搬运车辆及系统解决方案; 正面吊、堆高机、牵引车、防爆叉车、越野叉车等多样化产品。



宝鸡合力叉车有限公司
BAOJI HELI FORKLIFT CO.,LTD.
地址 / 陕西省宝鸡市金台区宝福路127号
电话 / 0917-3571231 (营销部)
传真 / 0917-3668884 (营销部)

网址 / <http://www.helichina.com/bjhl/>
E-MAIL / bjhl@helichina.com

* 本公司保留更改产品设计和规格的权利, 恕不另行通知。
* Our products are subject to improvements and changes without notice.

1-1.8 t

K2系列内燃平衡重式叉车

K2 series Internal Combustion Counterbalanced Forklift Truck



» 整车优势 FEATURES OF THE COMPLETED TRUCK

- » 整机外观简洁流畅,富有时代感
The appearance of the whole machine is simple and smooth, with a sense of The Times.
- » 配置四缸水冷发动机,整机动力性能优越
Equipped with four cylinder water - cooled engine, the over all power performance is superior.
- » 高置进气口和大通道进气系统,延长发动机寿命
High air intake and large channel air intake system, prolong engine life.
- » 采用整体位延成行引擎罩,强度更好
The whole position is extended into a row of engine hood, better strength.
- » 合理的人机工程,操纵更加轻松舒适
Reasonable man-machine engineering, more easy and comfortable operation.
- » 新型方向盘调整机构,舒适性更高
New steering wheel adjustment mechanism, higher comfort.



LED灯具 LEDluminaire



国四排放动力 Power of emission



可靠的转向桥 Reliable steering bridge



宽视野门架 Wide view mast



新式机罩 The new hood



液晶仪表 LCD meters

选装配置 Optional

可选属具	Available attachment	可选配置	Optional
侧移器	Side shifter	驾驶室	Driver' scab
倾翻叉	Tipping fork	高排气	High air exhausting device
卷子夹	Paper roll clamp	灭火器	Fire extinguisher
宽视野二级全自由门架	Wide view free-lift mast(two-stage)	后工作灯	Rear working lamp
宽视野三级全自由门架	Wide view free-lift mast(three-stage)	实心轮胎	Solid tyre
		警示灯	Warning light

宽视野基本型门架 WIDE VIEW MAST

门架型号 mast model	最大起升高度 Max. lifting height (mm)	承载能力(载荷中心为500mm)(kg) load capacity (load center 500mm)			门架全高 (货叉落地) (mm) mast overall height (fork to the ground)	门架倾角 (前/后)(°) mast tilt angle front/real	整车自重 (kg) service weight		
		CPC(D)10	CPC(D)15	CPC(D)18			CPC(D)10	CPC(D)15	CPC(D)18
M200	2000	1000	1500	1750	1495	6/12	2237	2637	2837
M250	2500	1000	1500	1750	1745	6/12	2268	2668	2868
M300	3000	1000	1500	1750	1995	6/12	2300	2700	2900
M330	3300	1000	1500	1750	2145	6/12	2320	2720	2920
M350	3500	1000	1500	1750	2245	6/12	2333	2733	2933
M370	3700	1000	1500	1750	2345	6/6	2345	2745	2945
M400	4000	1000	1500	1700	2545	6/6	2394	2794	2994
M425	4250	1000	1400	1650(*1750)	2670	6/6 *6/12	2410	2810	3010
M450	4500	950	1350	1550(*1700)	2795	6/6 *6/12	2426	2826	3026
M500	5000	930	1000(*1250)	1000(*1600)	3045	6/6 *6/6	2459	2859	3059
M550	5500	900	900(*1500)	950(*1500)	3345	6/6 *3/6	2520	2920	3120
M600	6000	600(*850)	600(*1050)	600(*1400)	3595	6/6 *3/6	2552	2952	3152

二级全自由门架 WIDE VIEW FULL FREE 2-STAGE MAST

门架型号 mast model	最大起升高度 Max. lifting height (mm)	承载能力(载荷中心为500mm)(kg) load capacity (load center 500mm)			门架全高 (货叉落地) (mm) mast overall height (fork to the ground)	门架倾角 (前/后)(°) mast tilt angle front/real	整车自重 (kg) service weight		
		CPC(D)10	CPC(D)15	CPC(D)18			CPC(D)10	CPC(D)15	CPC(D)18
ZM200	2000	1000	1500	1750	1495	6/12	2280	2680	2880
ZM250	2500	1000	1500	1750	1745	6/12	2312	2712	2912
ZM300	3000	1000	1500	1750	1995	6/12	2346	2746	2946
ZM330	3300	1000	1500	1750	2145	6/12	2368	2768	2968
ZM350	3500	1000	1500	1750	2245	6/12	2383	2783	2983
ZM370	3700	1000	1500	1750	2345	6/6	2395	2795	2995
ZM400	4000	1000	1500	1700	2545	6/6	2443	2843	3043
ZM425	4250	1000	1400	1650(*1750)	2670	6/6 *6/12	2462	2862	3062
ZM450	4500	950	1350	1550(*1700)	2795	6/6 *6/12	2481	2881	3081
ZM500	4750	930	1000(*1600)	1000(*1600)	3045	6/6 *6/6	2515	2915	3115
ZM550	5500	900	900(*1150)	950(*1500)	3345	*3/6	2576	2976	3176
ZM600	6000	600(*850)	600(*1050)	600(*1400)	3595	*3/6	2610	3010	3210

三级全自由门架 WIDE VIEW FULL FREE 3-STAGE MAST

门架型号 mast model	最大起升高度 Max. lifting height (mm)	承载能力(载荷中心为500mm)(kg) load capacity (load center 500mm)			门架全高 (货叉落地) (mm) mast overall height (fork to the ground)	门架倾角 (前/后)(°) mast tilt angle front/real	整车自重 (kg) service weight		
		CPC(D)10	CPC(D)15	CPC(D)18			CPC(D)10	CPC(D)15	CPC(D)18
ZSM360	3600	1000	1450	1750	1790	6/6	2394	2794	2994
ZSM400	4000	1000	1400	1600	1925	6/6	2418	2818	3018
ZSM435	4350	950	1300	1500(*1700)	2040	6/6 *6/6	2442	2842	3042
ZSM450	4500	950	1300	1500(*1650)	2090	6/6 *6/6	2453	2853	3053
ZSM470	4700	930	1280	1450(*1600)	2160	6/6 *6/6	2469	2869	3069
ZSM480	4800	920	1250	1400(*1580)	2190	6/6 *6/6	2477	2877	3077
ZSM500	5000	900	1000(*1250)	1000(*1550)	2290	6/6 *6/6	2498	2898	3098
ZSM540	5400	750(*900)	800(*1150)	800(*1480)	2415	6/6 *3/6	2523	2923	3123
ZSM600	6000	550(*850)	550(*1050)	550(*1380)	2640	6/6 *6/6	2595	2995	3195
ZSM650	6500	*850	*1000	*1250	2840	3/3 *3/3	2633	3033	3233
ZSM700	7000	*650	*750	*900	3025	*3/3	2672	3072	3272

注: 1、*为双胎对应的额定载重量
2、表中自重为双胎重量: +110kg

Note: 1:* refers to rated capacity with double tires.
2:The service weight is the weight of truck with dual tyres:+110kg.